

PERFORMANCE:

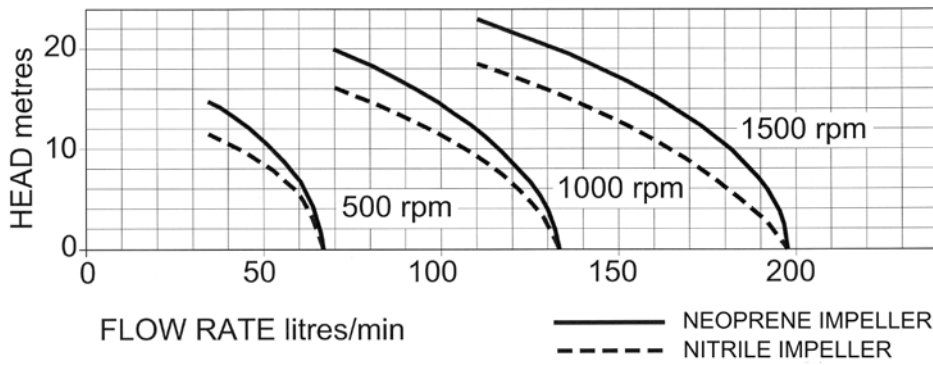

MODEL	Maximum flow rate		Maximum head	
	l/min	gall/min	metres	feet
52200-2011	195	43	23	75
52200-2003	195	43	18	59

Max Power absorbed 1100 watt at 1500rpm

DIMENSIONS:

WEIGHT: 5Kg

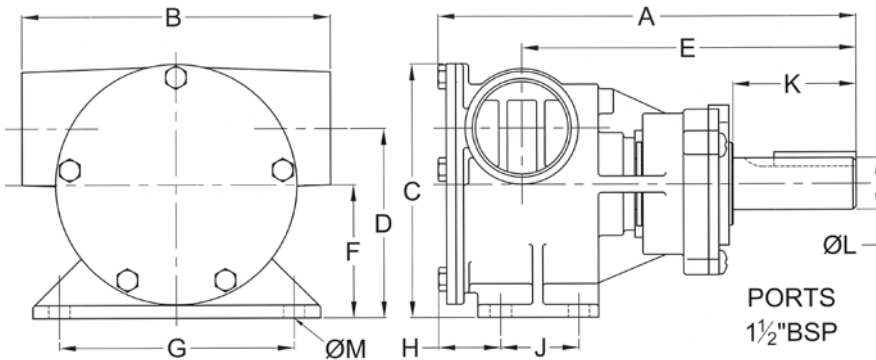

A	B	C	D	E	F	G	H	J	K	ØL	M
203	150	124	93	163	65	114	30	38	60	Ø25	Ø10

MATERIALS OF CONSTRUCTION:

Body	Bronze
Impeller	Neoprene or Nitrile
Wearplate	Replaceable
Shaft	Stainless steel type 316
Shaft seal	Mechanical, Carbon-Ceramic
Bearings	Twin row, ball type
Port type	1 1/2" BSP to BS21 (DIN2999)

MODELS:

52200-2011 Standard Neoprene Impeller

52200-2003 Oil resistant Nitrile

52200-2021 High pressure Neoprene



a xylem brand

BRONZE FLEXIBLE IMPELLER PEDESTAL PUMP

52200 SERIES



PUMP with 1 1/2" BSP PORTS

- * Constructed from marine quality bronze and stainless steel
- * Self-prime from dry up to 3m
- * Easy to service and maintain
- * Will tolerate abrasive wear
- * Handles hard and soft solids without clogging
- * Can pump in either direction
- * Will not airlock



Xylem Water Solutions UK Ltd
Bingley Road • Hoddesdon • Hertfordshire • EN11 0BU • UK

Telephone: +44 (0)1462 480380 Fax: +44 (0)1462 482422
mail@cleghorn.co.uk www.jabscoshop.com

DOC600/12